



ELIPSE INTEGRA® HALF-FACE MASK + HESPA™ P3 DUST (R) Filters

TDS
Technical
DataSheet



Standards

EN140: 1998 Mask Body
EN143: 2000+A1: 2006 P3 RD
EN166 Class 1.B.K.N. (Anti-Fog & Anti-Scratch)
CE 2797 - UKCA 0086

Efficiency

P3 >99,95% for 0,3 μ particulate

Weight

Mask + Filter: net (S/M) 203 g; (M/L) 211 g
gross (S/M) 292 g; (M/L) 324 g
Filter: net 18 g each; both net 36 g, gross 59 g

Shelf Live

5 years (mask & filters) See storage conditions on Instructions for Use.
Filters are re-usable and changeable.

Material

- Mask:** Medical grade TPE Conforms to ISO 10993-10: 2010 for irritations. Mask body latex and silicone free, odour free. Valve Body in Nylon, Inhalation/Exhalation diaphragm in Silicone. 4 point adjustable elasticated head and neck strap with comfort pad in TPE.
- Filters:** Mechanical type multi-layer HESPA Synthetic media with TPE flexible overmolded / encapsulated.
- Goggle:** Polycarbonate with flow coating overmolded into soft TPE, permanently attached to the mask body by stainless steel clips.

Production

United Kingdom
100% of filters NaCl Tested

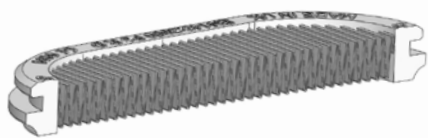

Encapsulation (patented technology)
645 mm; length of actual media in each filter

Code	Description	Quantity
SPR407(S/M) SPR406 (M/L)	P3 Elipse Integra complete with P3 filters	5 pcs. per box
SPR316	Elipse P3 replacement filters	10 sets of 2 pcs. per box
SPM007	Integra case	5 pcs. per box
SPM520	Peel off visor x 10	10 sets per box
SPM414	Portacount Face Fit Kit adaptor	50 sets of 10 pcs. per box

Applications - dust, mist and fumes



Grinding

Metal Fumes and Dust



Construction

Silica Dust, Abestos, Concrete Dust, Stone Dust, Aggregate Dust, Wood Dust, Cement Dust, Mold



Mining

Coal Dust, Silica Dust



Manufacturing

Glass Fibres, Composite Fibres, Lead Fumes



Food

Poultry, Powders (Dairy), Spices, Grain Dust



Pharmaceutical

Powders, Viruses

Authorized GVS Distributor



BLASTLINE®

Blastline India Pvt. Ltd.
Blastline Corporate Chambers,
Kaloor- Perandoor Road, Elamakkara
Kochi, Kerala - 682026, IN

Contact us

